

**LOS ANGELES COUNTY
DEPARTMENT OF PUBLIC WORKS**

BENCHMARKS



ARTESIA QUAD

**2005 ADJUSTMENT
2005 BASELINE
NAVD 88 DATUM FOOT/METER**

PREFACE

The Department of Public Works level net is composed of more than 1,700 miles or 2720 kilometers of levels supporting in excess of 9,000 benchmarks. Previously when a major readjustment of the net was undertaken, to emphasize the complete break with previous elevations, the CY, CG, and CL, series benchmarks were re-labeled DY, DG, and DL, respectively. Beginning in 1993 the Baseline readjustment year will be indicated on Baseline BM's, as indicated below (*). Henceforth all BM numbers will be labeled as a Y, G, or L series that will no longer indicate the major adjustment year.

To facilitate the adjustment, indexing and distribution of the adjusted values of the net, the county territory was divided into 33 quads or areas. For the identification purposes each quad was given a name (i.e. "Rosemead", "La Mirada", and "Santa Fe"...etc). When benchmarks and elevations in the quad are used, the name of the bench and quad must be stated in the description, i.e.:

(*)	BASELINE	90.057	L&BR IN CTR OF CB RET @ NE COR	Y 9191
	(1990)	295.461	LA HABRA BLVD & VALLEY HOME AVE	

It is expected that this general adjustment will for the most part remain sound for 8 to 10 years. Updating constrained adjustments will continue in the future. When a quad is readjusted, new elevations will be published and the date of readjustment will be noted in the benchmark description. Two benchmarks with different adjustment dates will not normally agree with each other.

The basic accuracy of the net is reflected by an indicated field probable error of ± 0.017 feet per mile (4mm per kilometer) of leveling as determined from conditions of closure. However, many years of experience in vertical control in the greater Los Angeles basin and Antelope Valley indicates that because of varying degrees of subsidence and heaving, the true datum is recovered only by obtaining substantial agreement of a number of benchmarks.

The users of this network of benchmarks are invited to assist in its maintenance by notifying this department of cases of obliteration, apparent mistakes in descriptions or elevations, and the disturbance of benchmarks.

Datum: North American Vertical Datum of 1988 (NAVD88)

Note: NAVD 1988 minus approximately 2.3 feet (70 cm) equals NGVD 1929 Datum. For more accurate equations at individual benchmarks refer to previous publications.

Abbreviations used in Benchmark Descriptions

Abbreviations	Descriptions	Abbreviations	Descriptions
<i>ABUT</i>	Abutment	<i>LT</i>	Lead and Tack
<i>ALG</i>	Along	<i>LACE</i>	Los Angeles City Engineer
<i>ANG PT</i>	Angle Point	<i>LACS</i>	La County Engineer
<i>B/W</i>	Back of Walk	<i>LAFC</i>	La County Flood Control
<i>BCR</i>	Begin Curb Return	<i>L&BN</i>	Lead and Bench Nail
<i>BC</i>	Begin Curve	<i>L&BR</i>	Lead and Brad
<i>BLDG</i>	Building	<i>L&N</i>	Lead and Nail
<i>BM</i>	Benchmark	<i>L&SPK</i>	Lead and Spike
<i>BT SPK</i>	Boat or Bolt Spike	<i>L&T</i>	Lead and Tack
<i>BR CAP</i>	Brass Cap Monument	<i>MCR</i>	Middle Curb Return
<i>C B</i>	Catch Basin	<i>MKD</i>	Marked
<i>CTR</i>	Center	<i>MC</i>	Middle Curve
<i>C/L</i>	Centerline	<i>MON</i>	Monument
<i>C/L INT</i>	Centerline Intersection	<i>N/O</i>	North of
<i>C/L PROD</i>	Centerline Produced	<i>NR</i>	Near
<i>CONC</i>	Concrete	<i>OPP</i>	Opposite
<i>COR</i>	Corner	<i>PI</i>	Point of Intersection
<i>COE</i>	Corps of Engineers	<i>PK&W</i>	PK Nail and Washer
<i>CULV</i>	Culvert	<i>P/L</i>	Property Line
<i>CYN</i>	Canyon	<i>POST</i>	Point on Simi-Tangent
<i>CB</i>	Curb	<i>PP</i>	Power Pole
<i>CS MON</i>	Co. Eng. Monument	<i>PVMT</i>	Pavement
<i>CT SPK</i>	Cut Spike	<i>PROD</i>	Produced
<i>DPW</i>	Dept of Public Works	<i>RD</i>	Road
<i>DR</i>	Driveway	<i>RDBM</i>	Road Dept Benchmark
<i>E/O</i>	East of	<i>RDBM TAG</i>	Road Dept Benchmark Tag
<i>ECR</i>	End Curb Return	<i>RR</i>	Railroad
<i>EC</i>	End Curve	<i>R/W</i>	Right of Way
<i>ENT</i>	Entrance	<i>SDMH</i>	Storm Drain Manhole
<i>FL</i>	Flow line	<i>SMH</i>	Sewer Manhole
<i>FTG</i>	Footing	<i>SPK</i>	Spike
<i>FRWY</i>	Freeway	<i>ST&W</i>	Spike Tin and Washer
<i>F/W</i>	Front of Walk	<i>S/O</i>	South of
<i>GAR</i>	Garage	<i>TP</i>	Telephone Pole
<i>HDWL</i>	Head Wall	<i>USC&GS</i>	US Coast and Geodetic Survey
<i>HSE</i>	House	<i>USGS</i>	US Geological Survey
<i>HWY</i>	Highway	<i>WK</i>	Walk
<i>INT</i>	Intersection	<i>W/O</i>	West of
<i>IP</i>	Iron Pipe		

QUAD COVERAGE INDEX MAP

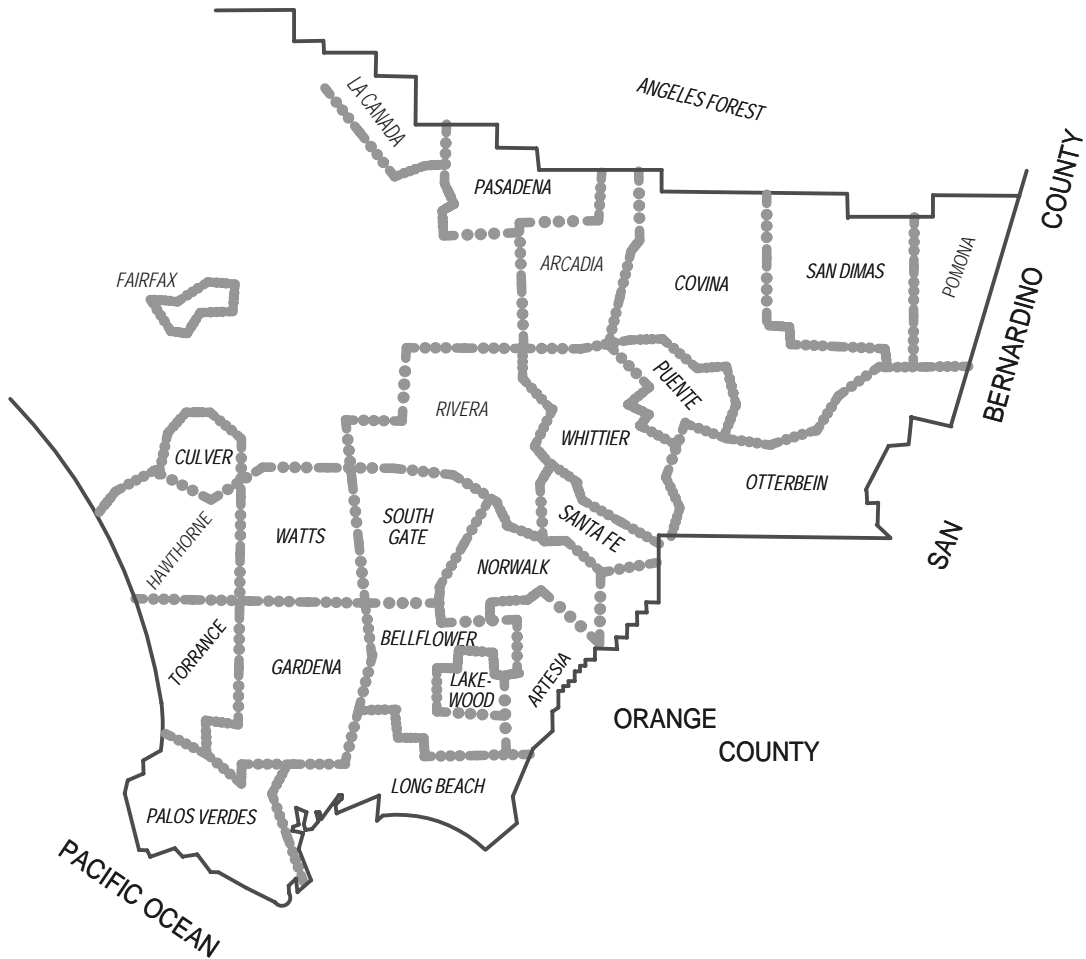
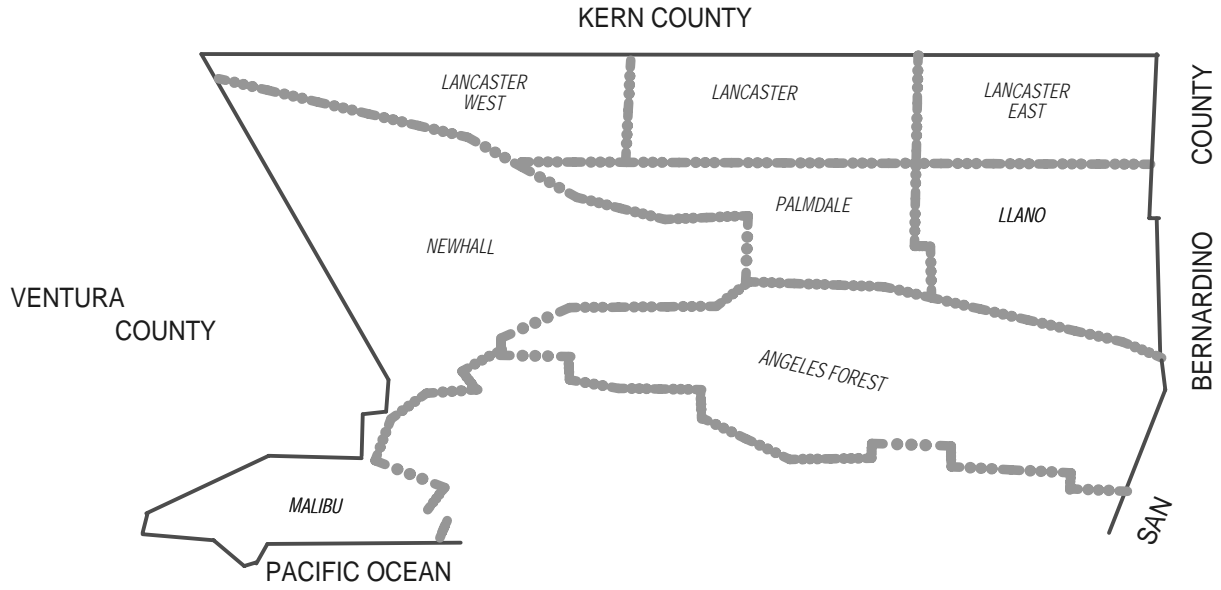

ARTESIA QUAD INDEX

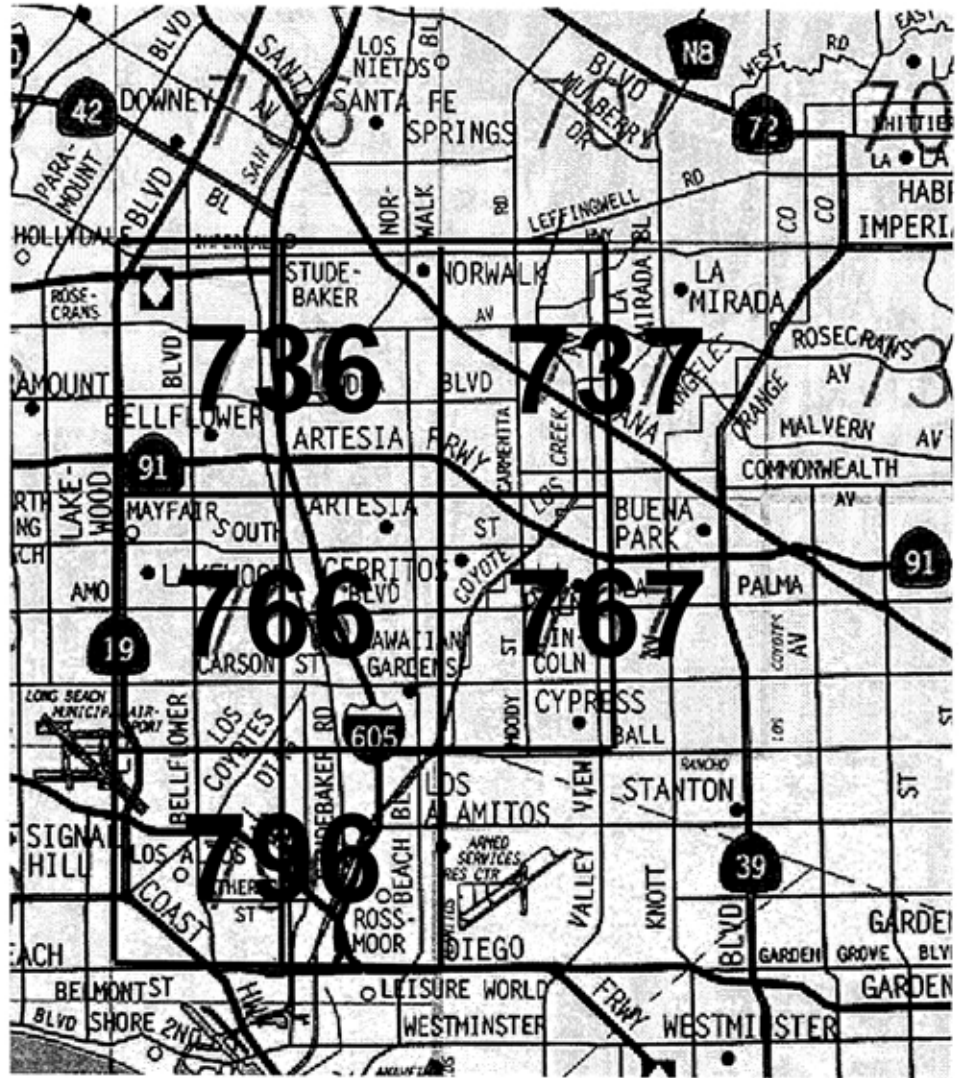

**NUMBERS REFER
TO THOMAS BROS
PAGE NUMBERS**

**EACH THOMAS BROS
PAGE IS DIVIDED INTO
TWO INDEX PAGES
EAST AND WEST**

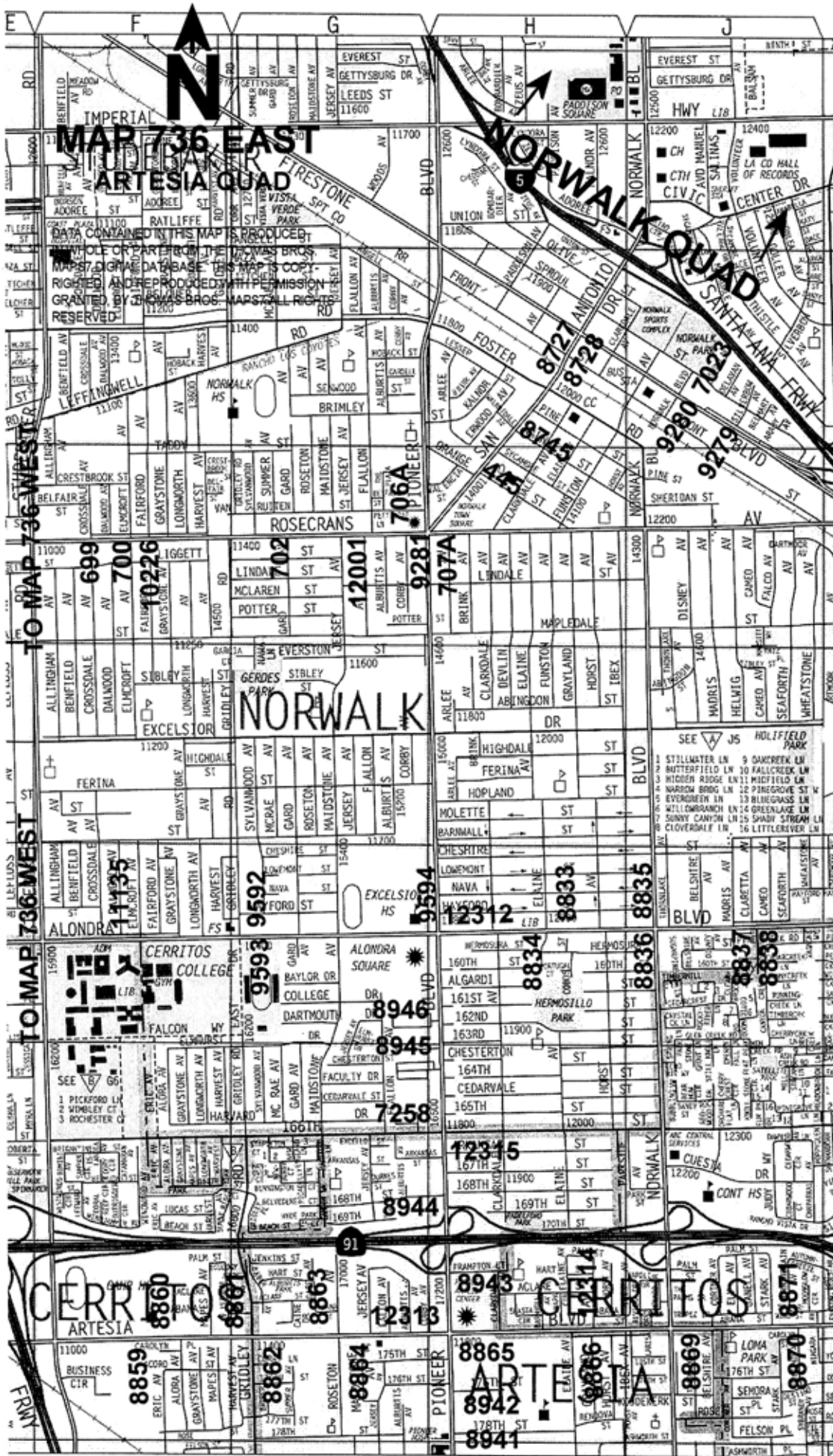

MAP 736 EAST
ARTESIA QUAD

NORWALK QUAD

TO MAP 736 WEST

TO MAP 737 WEST

TO MAP 736 WEST

TO MAP 737 WEST

TO MAP 736 WEST

TO MAP 737 WEST

TO MAP 766 EAST



DATA CONTAINED IN THIS MAP IS PRODUCED BY THE CITY OF NORWALK, CALIFORNIA. THE CITY OF NORWALK IS NOT RESPONSIBLE FOR ANY ERRORS OR OMISSIONS. THE CITY OF NORWALK IS NOT RESPONSIBLE FOR ANY DAMAGES, INCLUDING CONSEQUENTIAL DAMAGES, ARISING FROM THE USE OF THIS MAP. THE CITY OF NORWALK IS NOT RESPONSIBLE FOR ANY DAMAGES, INCLUDING CONSEQUENTIAL DAMAGES, ARISING FROM THE USE OF THIS MAP.

699

700

702

706A

707A

9281

9282

9283

9284

9285

9286

9287

9288

9289

9290

9291

9292

9293

9294

9295

1135

9592

9593

9594

9595

9596

9597

9598

9599

9600

9601

9602

9603

9604

9605

9606

9607

9608

9609

9610

8859

8860

8861

8862

8863

8864

8865

8866

8867

8868

8869

8870

8871

8872

8873

8874

8875

8876

8877

8878

8859

8860

8861

8862

8863

8864

8865

8866

8867

8868

8869

8870

8871

8872

8873

8874

8875

8876

8877

8878

8859

8860

8861

8862

8863

8864

8865

8866

8867

8868

8869

8870

8871

8872

8873

8874

8875

8876

8877

8878

8859

8860

8861

8862

8863

8864

8865

8866

8867

8868

8869

8870

8871

8872

8873

8874

8875

8876

8877

8878

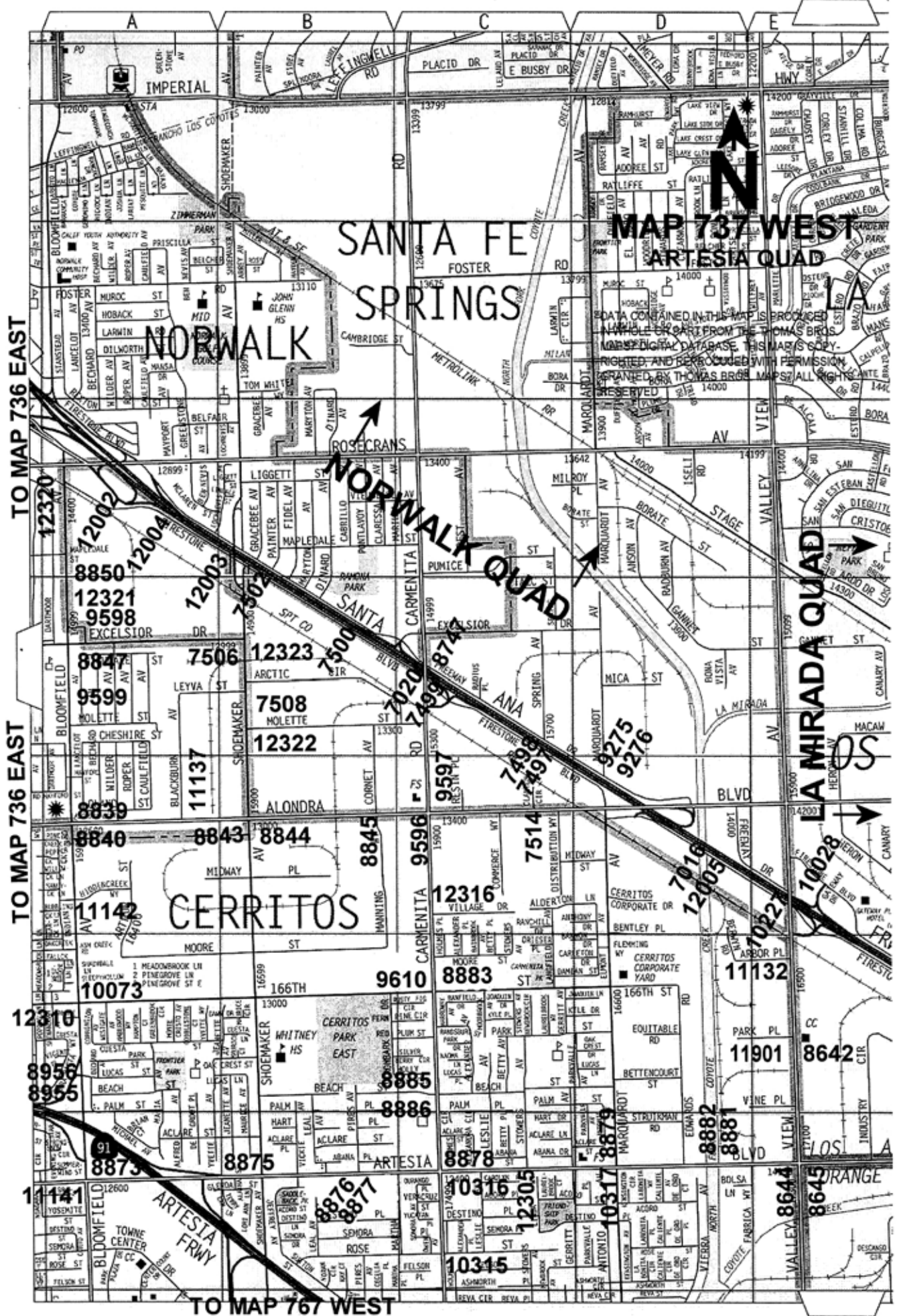

**MAP 737 WEST
ARTESIA QUAD**

TO MAP 736 EAST

TO MAP 736 EAST

TO MAP 736 EAST

TO MAP 767 WEST

DATA CONTAINED IN THIS MAP IS PROVIDED AS A SERVICE FROM THE THOMAS BROS. MAPS DIGITAL DATABASE. THIS MAP'S COPY IS UNLAWFUL AND REPRODUCED WITH PERMISSION BY THOMAS BROS. MAPS. ALL RIGHTS RESERVED.

NORWALK

SANTA FE SPRINGS

NORWALK QUAD

CERRITOS

LA MIRADA QUAD

ARTESIA FRWY

ORANGE

TO MAP 736 EAST

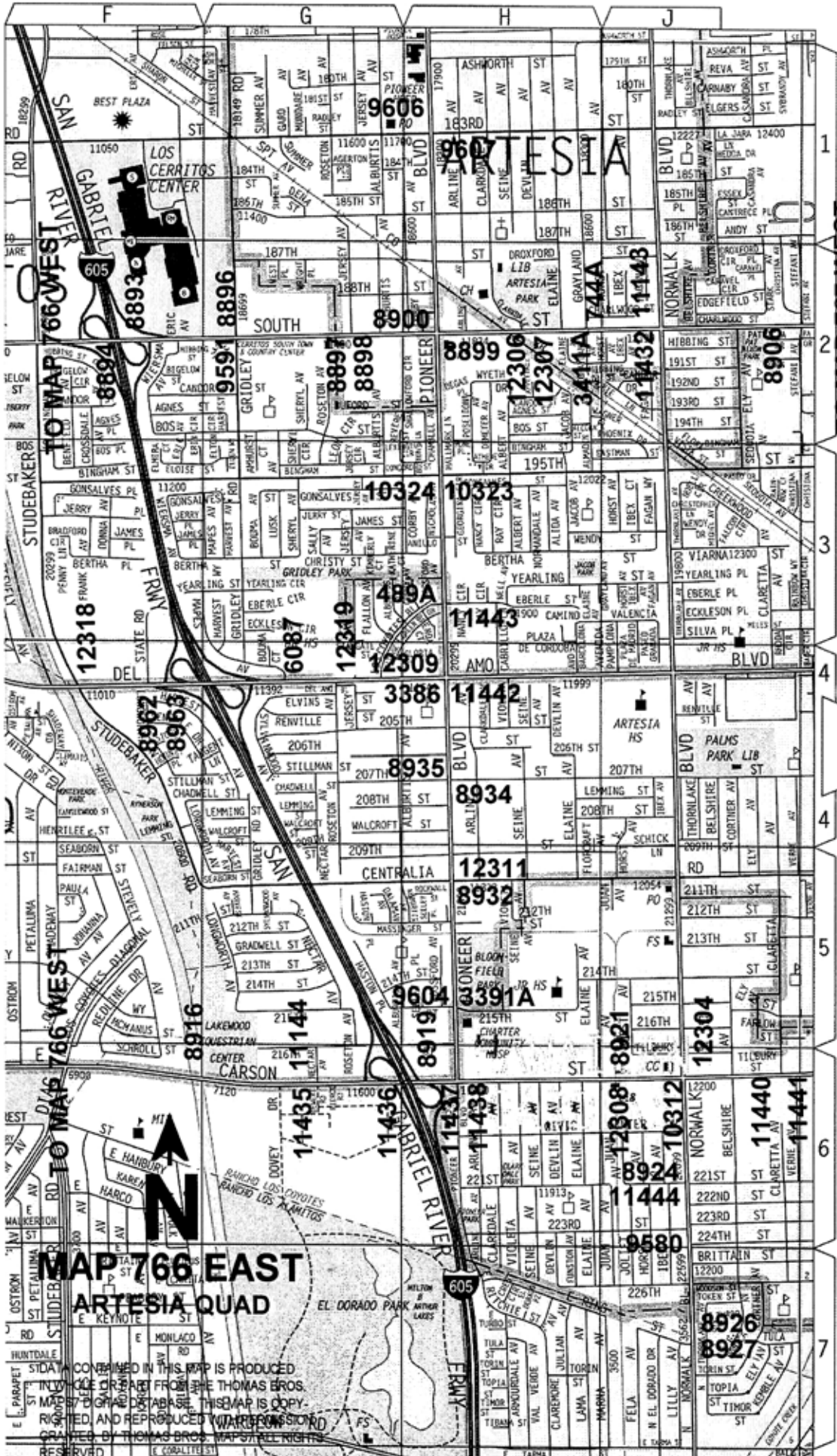

MAP 766 EAST
ARTESIA QUAD

CONTAINED IN THIS MAP IS PRODUCED
 FROM THE THOMAS BROS.
 MAPS AND PLANS. THIS MAP IS COPY-
 RIGHTEDED AND REPRODUCED WITH PERMISSION
 BY THOMAS BROS. MAPS AND PLANS.
 ALL RIGHTS RESERVED.

TO MAP 796 EAST

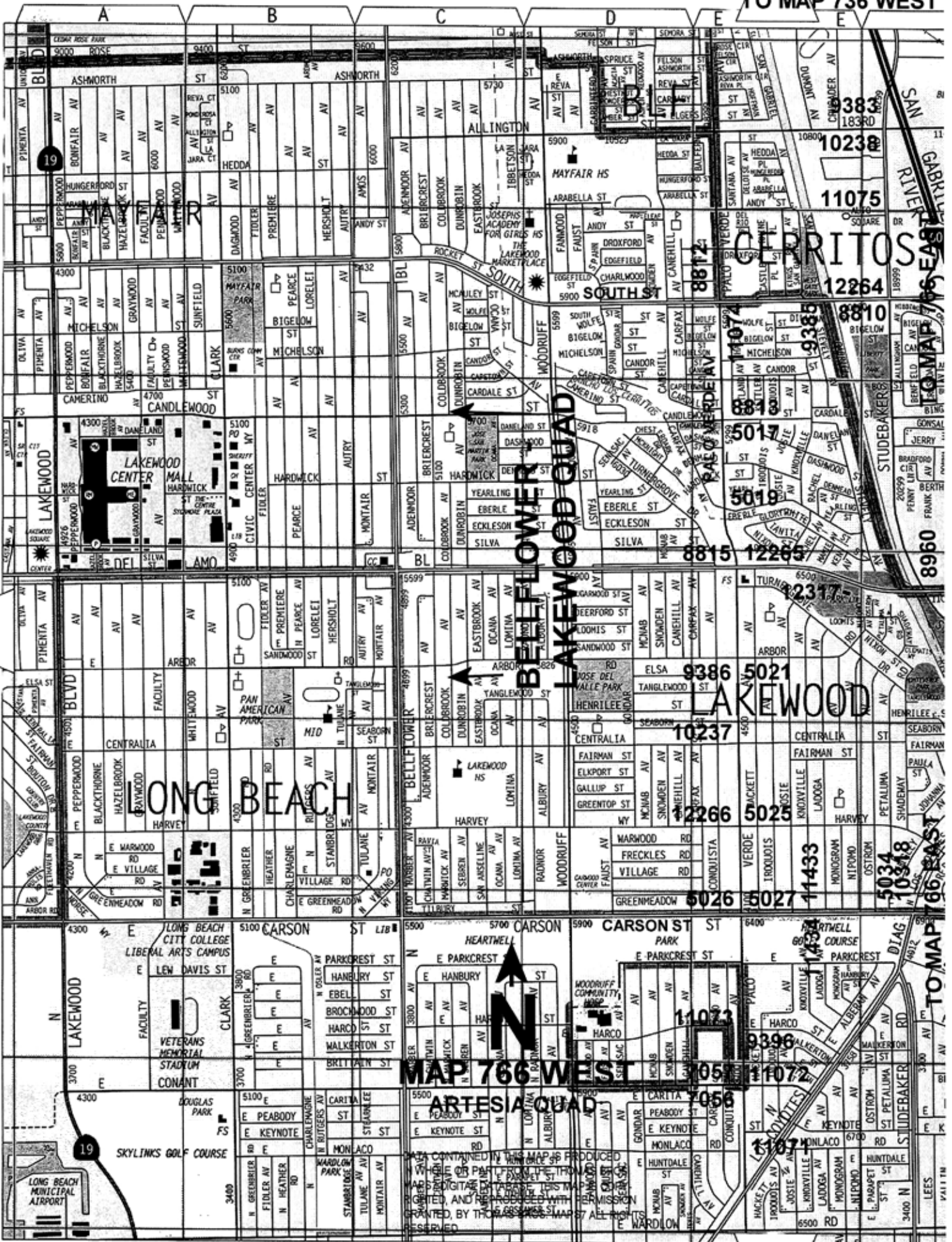

TO MAP 737 WEST

TO MAP 737 WEST

TO MAP 766 EAST

TO MAP 766 EAST

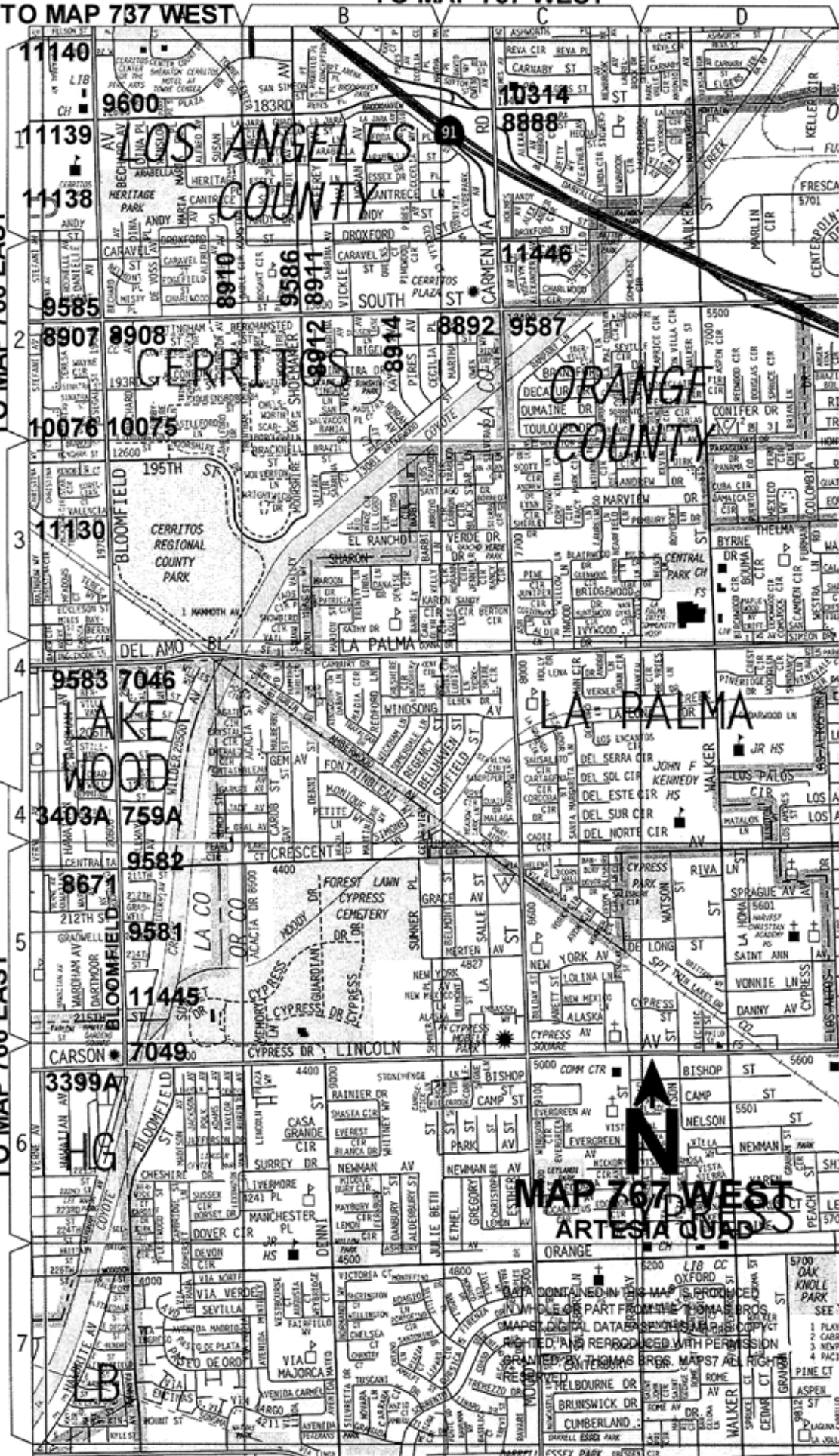

MAP 767 WEST
ARTESIA QUAD



- 1 PLAY
- 2 CABR
- 3 NEAP
- 4 PAC1

SEE: PINE CT

QUAD YEAR	ELEV FOOT/METER	DESCRIPTION	BM NUMBER
BASELINE (2005)	95.002 28.957	L&T IN N CB 1.5M(5') E/O BCR @ NE COR SAN ANTONIO DR & SYCAMORE ST	Y 445
ARTESIA (2005)	42.147 12.846	SQ HD SPK IN W CB 30M(98FT) S/O BCR @ SW COR PIONEER BL & LOS COYOTES BL	Y 489A
BASELINE (2005)	83.006 25.300	RD HD SPK IN W CB 8.5M(28') N/O BCR @ NW COR WOODRUFF AVE & WASHINGTON ST	Y 695
BASELINE (2005)	86.643 26.409	L&N IN S CB 300MM(1') E/O BCR @ SE COR ROSECRANS AVE & CROSSDALE AVE	Y 699
BASELINE (2005)	86.910 26.490	L&N IN S CB 300MM(1') E/O BCR @ SE COR ROSECRANS AVE & ELMCROFT AVE	Y 700
BASELINE (2005)	87.285 26.605	L&N IN S CB 300MM(1') E/O BCR @ SE COR ROSECRANS AVE & GARD AVE	Y 702
BASELINE (2005)	88.619 27.011	CS MON IN WELL IN WALK @ NW COR ROSECRANS AVE & PIONEER BL 26M(85') N/O & 12M(39.5') W/O C/L INT MKD (WHITTIER C 124 1959)	Y 706A
BASELINE (2005)	89.171 27.179	RDBM MON FL IN WALK @ SW COR ROSECRANS AVE & ARLEE AVE 25M(82') S/O & 6M(20') W/O C/L INT MKD (BM 184)	Y 707A
ARTESIA (2005)	47.692 14.537	RDBM TAG IN S CB 300MM(1') W/O BCR @ SW COR SOUTH ST & GRAYLAND AVE	Y 744A
ARTESIA (2005)	39.348 11.993	LACO RDBM TAG IN E CB @ N END C. B. BLOOMFIELD AVE & 87M(285') N/O C/L LEMMING ST	Y 759A
BASELINE (2005)	75.735 23.084	L&T IN CB RET 300MM(1') E/O BCR @ SW COR ALONDRA BLVD & WOODRUFF AVE	Y 960
BASELINE (2005)	92.175 28.095	RDBM TAG IN S CB ROSECRANS AVE 12.2M S/O C/L @ ANGLE PT IN CB 152M W/O BRIDGE OVER SAN GABRIEL RIVER & E/O DRWY TO PARKING LOT	Y 1989A
BASELINE (2005)	101.005 30.786	L&BN IN N CB ROSECRANS AVE @ NE COR BRIDGE OVER SAN GABRIEL RIVER 7M(23') N/O C/L & 300MM(1') W/O E END	Y 2495
BASELINE (2005)	103.349 31.501	L&BN IN N CB ROSECRANS AVE @ NW COR BRIDGE OVER SAN GABRIEL RIVER 7M(23') N/O C/L & 300MM(1') E/O W END	Y 2496
BASELINE (2005)	75.226 22.929	L&T IN N CB 300MM(1') E/O BCR @ NE COR ALONDRA BLVD (SERV RD) & DUMONT AVE	Y 2616
BASELINE (2005)	75.783 23.099	L&T IN N CB 300MM(1') E/O BCR @ NE COR ALONDRA BLVD (SER RD) & LEIBACHER AVE	Y 2617
ARTESIA (2005)	45.691 13.927	SET L&BN IN NW COR OF CONC BLOCK 2FT HIGH 33FT S OPP LIGHT STANDARD NO 71-35 70FT N/O C/L DEL 700FT E OF FEED MILL	Y 3384
ARTESIA (2005)	39.517 12.045	L&T IN N CB RET 2.4M(8') W/O BCR @ NW COR 205TH ST & PIONEER BLVD	Y 3386
ARTESIA (2005)	35.557 10.838	RDBM TAG IN W CB 1M(3.3') N/O BCR @ NW COR PIONEER BLVD & 215TH ST	Y 3391A

QUAD YEAR	ELEV FOOT/METER	DESCRIPTION	BM NUMBER
ARTESIA (2005)	44.785 13.651	COE BR DISK IN TOP OF WINGWALL NW COR BR 55-147 OVER COYOTE CREEK 45M(148') E/O & 12M(39.4') N/O C/L INT BLOOMFIELD AVE & CARSON ST MKD (CC 13 1957)	Y 3399A
ARTESIA (2005)	38.948 11.871	LACO RDBM TAG IN W CB BLOOMFIELD & 90M(295') N/O C/L LEMMING ST	Y 3403A
ARTESIA (2005)	47.567 14.498	RDBM TAG IN S CB 300MM(1') E/O BCR @ SE COR SOUTH ST & GRAYLAND AVE	Y 3411A
BASELINE (2005)	49.892 15.207	L&T IN S CB 900MM(3') W/O BCR @ SW COR PALO VERDE AVE & CANDLEWOOD ST	Y 5017
BASELINE (2005)	48.753 14.860	L&BR IN E CB 300MM(1') N/O BCR @ NE COR EBERLE ST & PALO VERDE AVE	Y 5019
BASELINE (2005)	43.511 13.262	L&BN IN N CB 22M(75') W/O BCR @ NW COR PALO VERDE AVE & ARBOR RD	Y 5021
BASELINE (2005)	38.415 11.709	L&BN IN E CB 300MM(1') S/O BCR @ SE COR PALO VERDE AVE & HARVEY WAY	Y 5025
BASELINE (2005)	38.705 11.797	RDBM TAG IN W CB 2M(6.5') N/O BCR @ NW COR CARSON ST & PALO VERDE AVE	Y 5026
BASELINE (2005)	38.663 11.785	RDBM TAG IN E CB 2M(6.5') N/O BCR @ NE COR CARSON ST & PALO VERDE AVE	Y 5027
ARTESIA (2005)	37.017 11.283	RDBM TAG IN W CB 300MM(1') S/O BCR @ NW COR CARSON ST & LOS COYOTES DIAGONAL	Y 5034
ARTESIA (2005)	41.720 12.716	L&BN N. CURB @ W END OF C B 7.9M(26FT) W/O BCR @ NW COR DEL AMO BLVD & MAPES AVE	Y 6087
BASELINE (2005)	21.899 6.675	CS MON IN WELL IN ST 2M(6.5') N/O S CF SPRING ST (SERV RD) & STUDEBAKER RD 35M(115') W/O & 23M(75.5') S/O C/L INT MKD (BM 8-33 1951)	Y 6160
BASELINE (2005)	68.103 20.758	COE BR CAP FL 1.5M(5') S/O SLY CF @ SE COR BRIDGE OVER N FORK COYOTE CREEK 6.7M(22') S/O C/L FIRESTONE BLVD (S SERV RD SANTA ANA FRWY) MKD (CC 37 1959)	Y 7016
BASELINE (2005)	80.811 24.631	RDBM TAG IN S END HDWL @ NE COR FIRESTONE BLVD & CARMENITA RD	Y 7020
BASELINE (2005)	96.388 29.379	STATE CALIF BR DISC IN CB 8M(26') S/O BCR @ SW COR FIRESTONE BLVD & NORWALK BLVD MKD (22-B-41)	Y 7023
BASELINE (2005)	82.701 25.207	L&T IN W CB 1.8M(6') S/O BCR @ SW COR WOODRUFF AVE & WASHINGTON ST	Y 7027
ARTESIA (2005)	41.510 12.652	RDBM TAG IN W CB 300MM(1') S/O BCR @ SW COR DEL AMO BLVD & BLOOMFIELD AVE	Y 7046
ARTESIA (2005)	44.656 13.611	COE BR DISK IN WING WALL @ SW COR BR OVER COYOTE CREEK 45M(147') E/O & 12M(40') S/O C/L INT BLOOMFIELD AVE & CARSON ST MKD (CC 12 1957)	Y 7049

QUAD YEAR	ELEV FOOT/METER	DESCRIPTION	BM NUMBER
BASELINE (2005)	39.870 12.152	COE MON IN E END CONC ABUT BRIDGE # B-1110 C/L SPRING ST @ LOS COYOTES CREEK MKD (CC 6 1957)	Y 7052
BASELINE (2005)	39.581 12.064	COE MON IN SW COR BRIDGE #B-1110 1.2M(4') S/O CF ON SPRING ST & LOS COYOTES CREEK MKD (CC #5 1957)	Y 7053
BASELINE (2005)	32.892 10.026	L&BN IN E CB 300MM(1') S/O BCR @ SE COR CONANT ST & PALO VERDE AVE	Y 7056
BASELINE (2005)	74.371 22.668	CS MON IN WELL 1.5M(5') N/O N CF HAYFORD ST & 22.6M(74') W/O C/L MC NAB ST MKD (BM 9-1A RE 5869 1961)	Y 7078
BASELINE (2005)	63.796 19.445	L&BN IN N CB 600MM(2') E/O BCR @ NE COR ARTESIA BLVD & STUDEBAKER RD	Y 7080
BASELINE (2005)	63.315 19.298	L&BN IN CB RET 1.5M(5') N/O BCR @ SW COR ARTESIA BLVD & STUDEBAKER RD	Y 7081
ARTESIA (2005)	67.307 20.515	L&BN W CB 2FT N BCR @ NW COR 166TH ST & PIONEER BLVD 64FT N & 30FT W C/L INT	Y 7258
BASELINE (2005)	69.980 21.330	L&BN IN S CB 8M(26') W/O C/L WLY MOST DRWY TO BLDG #13750 FIRESTONE BL (S SIDE 5 FRWY) @ PP #1119957E	Y 7497
BASELINE (2005)	71.176 21.695	L&BN IN S CB 17M(56') W/O C/L ELY MOST DRWY TO BLDG #13700 FIRESTONE BL (SLY SIDE 5 FRWY) & 402M(0.25MI) W/O MARQUARDT AVE	Y 7498
BASELINE (2005)	82.110 25.027	L&BN IN S CB FIRESTONE BLVD (S SIDE 5 FRWY) 7.6M(25FT) W/O BCR 6M(20FT) S/O C/L & 27.4M(90FT) W/O C/L CARMENITA RD OFF-RAMP	Y 7499
BASELINE (2005)	79.789 24.320	L&BN IN CTR OF HDWL 7M(23') S/O C/L FIRESTONE BLVD (S SIDE 5 FRWY) IN FRONT OF BLDG #13146 & 12.2M(40') E/O LOADING DOCK 483M(0.3MI) W/O CARMENITA RD	Y 7500
BASELINE (2005)	80.796 24.627	L&BN IN CONC FTG OF 2.4M(8') CHAIN LINK FENCE COR 13.4M(44') W/O C/L SHOEMAKER AVE & 11M(36') S/O C/L SPRR (S/O FIRESTONE BLVD)	Y 7502
ARTESIA (2005)	75.928 23.143	L&BN N CB 1FT W/O BCR @ NW COR SHOEMAKER AVE & EXCELSIOR DR 18FT N/O & 60FT W/O C/L INT MKD (BM)	Y 7506
ARTESIA (2005)	74.012 22.559	L&CALTRAN TAG N CB 1FT E/O BCR @ NE COR SHOEMAKER AVE & MOLETTE ST 20FT N & 70FT E C/L INT	Y 7508
ARTESIA (2005)	71.348 21.747	L&BN IN W CB 1M(3FT) N/O BCR @ NW COR ALONDRA BLVD & CLANTON CIR	Y 7514
BASELINE (2005)	51.945 15.833	CS MON IN S CB SPRING ST 900MM(3') E/O W END BRIDGE #53-1723 OVER (605)FRWY MKD (BM 8-28A 1965)	Y 8606
BASELINE (2005)	59.738 18.208	RDBM TAG IN E CB VALLEY VIEW AVE 2.4M(8FT) N/O C/L PROD PARK PL (@ S END C B)	Y 8642
BASELINE (2005)	56.709 17.285	CS BM MON IN S END C. B. 1.2M(4FT) N/O BCR @ NW COR ARTESIA BLVD & VALLEY VIEW AVE MKD (BM 8-1A 1968 RE 5869)	Y 8644
BASELINE (2005)	56.398 17.190	RDBM TAG IN N CB 600MM(2FT) E/O BCR @ NE COR ARTESIA BLVD & VALLEY VIEW AVE	Y 8645

QUAD YEAR	ELEV FOOT/METER	DESCRIPTION	BM NUMBER
ARTESIA (2005)	37.670 11.482	ORANGE CO BR CAP 300MM(1') E/O E CF 13M(43') N/O BCR @ NE COR BLOOMFIELD AVE & CENTRALIA RD MKD (BM RCE 7872) @ S END C. B.	Y 8671
BASELINE (2005)	98.867 30.135	RDBM TAG IN N CB 2.7M(9') E/O BCR @ NE COR FIRESTONE BLVD & SAN ANTONIO DR	Y 8727
BASELINE (2005)	98.475 30.015	LA. CO. DPW TAG IN CB RET 2.7M(9FT) E/O BCR @ SW COR SAN ANTONIO DR & FIRESTONE BLVD	Y 8728
BASELINE (2005)	101.042 30.798	COE MON IN E ABUT SE COR BRIDGE OVER SAN GABRIEL RIVER 9M(29.5') S/O C/L ROSECRANS AVE MKD (SG 22 1959)	Y 8743
BASELINE (2005)	85.285 25.995	CS BM MON IN WELL 1.2M(4') N/O CF 3M(9.8') W/O BCR @ NW COR ROSECRANS AVE & STUDEBAKER RD MKD (BM 6-2A 1970 RE 5869)	Y 8744
BASELINE (2005)	96.496 29.412	L&T IN N CB 300MM(1') E/O BCR @ NELY COR PINE ST & SAN ANTONINO DR	Y 8745
BASELINE (2005)	79.723 24.300	CSBM MON IN WELL 200MM(0.7') DN @ NE COR FIRESTONE BL & CARMENITA RD 38M(125') E/O & 10M(33') N/O C/L INT MKD (BM 2-2C 1970)	Y 8747
BASELINE (2005)	71.438 21.774	RDBM TAG IN E CB 600MM(2') N/O BCR @ NE COR 166TH ST & STUDEBAKER RD	Y 8808
BASELINE (2005)	52.894 16.122	CS MON S END CB 14M(46') N/O BCR @ NW COR SOUTH ST & STUDEBAKER RD MKD (BM 9-8C 1970)	Y 8810
BASELINE (2005)	53.333 16.256	RDBM TAG IN S CB 600MM(2') W/O BCR @ SE COR SOUTH ST & PALO VERDE AVE	Y 8812
BASELINE (2005)	50.129 15.279	L&T IN E CB 600MM(2') S/O BCR @ SE COR PALO VERDE AVE & CANDLEWOOD ST	Y 8813
BASELINE (2005)	28.815 8.783	RDBM TAG IN S CB 300MM(1') W/O BCR @ SE COR WARDLOW RD & PALO VERDE AVE	Y 8814
BASELINE (2005)	46.742 14.247	CS MON IN C. B. @ NW COR DEL AMO BL & PALO VERDE AVE 31M(102') W/O & 13M(43') N/O C/L INT MKD (BM 9-10A 1965)	Y 8815
ARTESIA (2005)	72.267 22.027	L&T IN W CB 3.4M(11') N/O BCR @ NW COR ALONDRA BLVD & ELAINE AVE	Y 8833
ARTESIA (2005)	72.512 22.102	RDBM TAG IN N CB 1M(3.3') E/O BCR @ NE COR ALONDRA BLVD & ELAINE AVE	Y 8834
ARTESIA (2005)	71.231 21.711	CS BM MON IN S END C. B. 1M(3.3') N/O BCR @ NW COR ALONDRA BLVD & NORWALK BLVD MKD (BM 41-7A 1970)	Y 8835
ARTESIA (2005)	71.302 21.733	RDBM TAG IN N CB 300MM(1') E/O BCR @ NE COR ALONDRA BLVD & NORWALK BLVD	Y 8836
ARTESIA (2005)	73.994 22.553	RDBM TAG IN S CB ALONDRA BLVD (SERV RD N) & 5.5M(18') W/O C/L PROD CLARETTA AVE	Y 8837
ARTESIA (2005)	73.632 22.443	RDBM TAG IN N CB (SERV RD) 300MM(1') E/O BCR @ NE COR ALONDRA BLVD & CLARETTA AVE	Y 8838

QUAD YEAR	ELEV FOOT/METER	DESCRIPTION	BM NUMBER
ARTESIA (2005)	73.223 22.318	L&T IN N CB 2M(7FT) W/O BCR @ NW COR ALONDRA BLVD & BLOOMFIELD AVE	Y 8839
ARTESIA (2005)	73.157 22.298	RDBM TAG IN E CB 300MM(2FT) N/O BCR @ NE COR ALONDRA BLVD & BLOOMFIELD AVE	Y 8840
ARTESIA (2005)	71.172 21.693	RDBM TAG IN S CB 1M(3FT) E/O BCR @ SW COR ALONDRA BLVD & SHOEMAKER AVE	Y 8843
ARTESIA (2005)	71.311 21.736	L&T IN S END C B 1.5M(5FT) N/O BCR @ NW COR ALONDRA BLVD & SHOEMAKER AVE	Y 8844
ARTESIA (2005)	73.499 22.403	RDBM TAG IN E CB 300MM N/O BCR @ NE COR ALONDRA BLVD & CORNET AVE 23.5M N & 8M E/O C/L INT	Y 8845
ARTESIA (2005)	79.015 24.084	RDBM TAG IN E CB 1FT S/O BCR @ SE COR BLOOMFIELD AVE & EXCELSIOR DR 42FT E & 68FT S C/L INT	Y 8847
ARTESIA (2005)	80.527 24.545	RDBM TAG IN W CB 1FT S/O BCR @ SW COR BLOOMFIELD AVE & MAPLEDALE ST 40FT W/O & 54FT S/O C/L INT	Y 8850
ARTESIA (2005)	77.162 23.519	RDBM TAG IN E CB 1FT S/O BCR @ SE COR STUDEBAKER RD & BARNWALL ST 57FT S & 40FT E/O C/L INT	Y 8853
ARTESIA (2005)	77.573 23.644	RDBM TAG IN NO CB 1FT E/O ECR @ NE COR STUDEBAKER RD & BARNWALL ST 20FT N & 78FT E/O C/L INT	Y 8854
ARTESIA (2005)	80.620 24.573	RDBM TAG IN S CB @ WEST END CB 4FT E/O ECR @ SE COR OF STUDEBAKER RD & EXCELSIOR DR 39FT S & 80FT E/O C/L INT	Y 8855
ARTESIA (2005)	83.292 25.387	RDBM TAG IN S CB 1FT E/O ECR @ SE COR STUDEBAKER RD & MAPLEDALE ST 70FT E & 18FT S C/L INT	Y 8857
ARTESIA (2005)	83.273 25.382	L & DPW TAG IN E CB 300MM(1FT) N/O BCR @ NE COR STUDEBAKER RD & MAPLEDALE ST	Y 8858
ARTESIA (2005)	67.256 20.500	RDBM TAG IN N CB IN FRONT GAHR HI SCHOOL 42FT N C/L ARTESIA BLVD & 375FT W/O C/L ALORA AVE	Y 8859
ARTESIA (2005)	67.783 20.660	RDBM TAG IN S CB 4FT W/O CB END 42FT S C/L ARTESIA BLVD & 375FT W/O C/L ALORA AVE	Y 8860
ARTESIA (2005)	62.749 19.126	RDBM TAG IN N CB 4FT E/O BCR @ NW COR ARTESIA BLVD & GRIDLEY RD 43FT N & 63FT W/O C/L INT	Y 8861
ARTESIA (2005)	62.316 18.994	RDBM TAG IN E CB 1FT S/O ECR @ NE COR ARTESIA BLVD & GRIDLEY RD 29FT E & 74FT N C/L INT	Y 8862
ARTESIA (2005)	59.489 18.132	RDBM TAG IN W CB 1FT S ECR @ SW COR ARTESIA BLVD & ROSETON AVE 77FT S & 17FT W C/L INT	Y 8863
ARTESIA (2005)	59.543 18.149	RDBM TAG IN S CB 1FT E BCR @ SE COR ARTESIA BLVD & ROSETON AVE 40FT S & 53FT E C/L INT	Y 8864
ARTESIA (2005)	59.228 18.053	RDBM TAG IN N CB 6FT W/O BCR @ NE COR ARTESIA BLVD & PIONEER BLVD 43FT N & 71FT E C/L INT	Y 8865
ARTESIA (2005)	56.911 17.347	RDBM TAG IN E EDGE OF CB @ SW COR ARTESIA BLVD & ELAINE AVE 40FT S & 52FT W C/L INT	Y 8866

QUAD YEAR	ELEV FOOT/METER	DESCRIPTION	BM NUMBER
ARTESIA (2005)	59.555 18.152	RDBM TAG IN N CB 6FT W/O BCR @ NE COR ARTESIA BLVD & NORWALK BLVD 42FT N & 59FT E C/L INT	Y 8869
ARTESIA (2005)	59.929 18.266	L & LS5411 TAG IN N CB @ BCR @ NW COR ARTESIA BLVD & STARK AVE 42FT N & 55FT W C/L INT	Y 8870
ARTESIA (2005)	60.176 18.342	L & LS5411 TAG IN N CB @ BCR @ NE COR ARTESIA BLVD & STARK AVE 42FT N & 55FT E C/L INT	Y 8871
ARTESIA (2005)	59.361 18.093	DPW TAG IN E CB 600MM(2') N/O BCR @ NE COR ARTESIA BLVD & BLOOMFIELD AVE	Y 8873
ARTESIA (2005)	58.299 17.770	RDBM TAG IN S CB 2FT E BCR @ SE COR ARTESIA BLVD & THE OFF RAMP OF THE NO BOUND ARTESIA FRWY 42FT S & 66FT E C/L INT	Y 8874
ARTESIA (2005)	56.937 17.354	DPW TAG IN N CB IN FRONT PUMPING STA 12.8M (42FT) N/O & 79M(250FT) E/O C/L INT ARTESIA BLVD & THE OFF RAMP OF THE N BOUND ARTESIA FRWY	Y 8875
ARTESIA (2005)	58.258 17.757	RDBM TAG IN SO CB ARTESIA BLVD 42FT S & 325FT W/O C/L PIRES AVE	Y 8876
ARTESIA (2005)	59.163 18.033	RDBM TAG IN S CB ARTESIA BLVD 42FT S & 213FT W/O C/L PIRES AVE	Y 8877
ARTESIA (2005)	59.990 18.285	RDBM TAG IN S CB 300MM(1') W/O BCR @ SE COR ARTESIA BLVD & CARMENITA RD	Y 8878
ARTESIA (2005)	56.801 17.313	CS MON IN WELL 600MM(2') N/O N CF 2M(6.5') E/O BCR @ NW COR ARTESIA BLVD & MARQUARDT AVE MKD (BM 8-2B 1970 RE 5869)	Y 8879
ARTESIA (2005)	63.841 19.459	FC TAG IN SW COR BRIDGE #53-277 OVER COYOTE CREEK 8M(26') S/O C/L ARTESIA BLVD 1M(3.3') E/O WEST END BRIDGE	Y 8881
ARTESIA (2005)	63.955 19.494	FC TAG IN SE COR BR #53-277 OVER N FORK COYOTE CREEK 8M(26') S/O C/L ARTESIA BLVD & 1M(3.3') W/O E END BRIDGE	Y 8882
ARTESIA (2005)	65.636 20.006	RDBM TAG IN E CB 1FT N BCR @ NE COR CARMENITA RD & 166TH ST 42FT E & 72FT N C/L INT	Y 8883
ARTESIA (2005)	63.094 19.231	RDBM TAG IN W CB 3FT N BCR @ NW COR CARMENITA RD & BEACH ST 58FT N & 42FT W C/L INT	Y 8885
ARTESIA (2005)	63.156 19.250	RDBM TAG IN S CB 4FT W ECR @ SW COR CARMENITA RD & BEACH ST 20FT S & 80FT W C/L INT	Y 8886
ARTESIA (2005)	51.993 15.848	RDBM TAG IN W CB 750MM(2.5') S/O BCR @ SW COR 183RD ST & CARMENITA RD @ C. B.	Y 8888
ARTESIA (2005)	45.524 13.876	L&N IN N CB 2M(6.5') E/O BCR @ NW COR CARMENITA RD & SOUTH ST	Y 8892
ARTESIA (2005)	72.733 22.169	RDBM TAG IN N CB SOUTH ST 9M(30') W/O C/L PROD OF N BOUND 605 FRWY OFF-RAMP	Y 8893
ARTESIA (2005)	72.381 22.062	RDBM TAG IN S CB 1.4M(4.7') W/O BCR @ SW COR SOUTH ST & OFF-RAMP OF N BOUND 605 FRWY	Y 8894

QUAD YEAR	ELEV FOOT/METER	DESCRIPTION	BM NUMBER
ARTESIA (2005)	52.901 16.124	CSBM MON FLUSH IN S END C. B. @ NE COR GRIDLEY RD & SOUTH ST 23M(75') N/O & 10M(33') E/O C/L INT MKD (BM 41-1A 1970 RE 5869)	Y 8896
ARTESIA (2005)	48.568 14.804	RDBM TAG IN W CB 150MM(0.5') S/O BCR @ NW COR SOUTH ST & JERSEY AVE	Y 8897
ARTESIA (2005)	48.649 14.828	RDBM TAG IN N CB 1M(3.3') E/O BCR @ NE COR SOUTH ST & JERSEY AVE	Y 8898
ARTESIA (2005)	49.518 15.093	RDBM TAG IN N CB 11M(36') W/O BCR @ NW COR SOUTH ST & PIONEER BLVD	Y 8899
ARTESIA (2005)	49.241 15.009	CSBM MON IN E CB 6M(20') N/O BCR @ NE COR SOUTH ST & PIONEER BLVD MKD (BM 41-2A 1970 RE 5869) @ S END C. B.	Y 8900
ARTESIA (2005)	47.555 14.495	RDBM TAG IN N CB SOUTH ST NR W P/L HSE #12423 119M(390') W/O C/L STEFANI AVE	Y 8906
ARTESIA (2005)	47.339 14.429	RDBM TAG IN W CB 300MM(1') S/O BCR @ NW COR SOUTH ST & BLOOMFIELD AVE	Y 8907
ARTESIA (2005)	47.378 14.441	RDBM TAG IN N CB 600MM(2') E/O BCR @ NE COR SOUTH ST & BLOOMFIELD AVE	Y 8908
ARTESIA (2005)	44.739 13.636	RDBM TAG IN N CB 2M(6.5') E/O BCR @ NE COR SOUTH ST & ALFRED AVE	Y 8910
ARTESIA (2005)	44.243 13.485	RDBM TAG IN N CB 54M(177') E/O BCR @ NE COR SOUTH ST & SHOEMAKER AVE @ C. B.	Y 8911
ARTESIA (2005)	44.199 13.472	RDBM TAG IN S CB 53M(174') E/O BCR @ SE COR SOUTH ST & SHOEMAKER AVE @ C. B.	Y 8912
ARTESIA (2005)	45.407 13.840	RDBM TAG IN S CB 300MM(1') E/O BCR @ SE COR SOUTH ST & PIRES AVE	Y 8914
ARTESIA (2005)	53.481 16.301	RDBM TAG NR CTR OF E ABUT OF BRIDGE #53-300L OVER SAN GABRIEL RIVER 300MM(1') S/O C/L CARSON ST	Y 8916
ARTESIA (2005)	35.709 10.884	RDBM TAG IN N CB CARSON ST & 1.5M(5') W/O WEST ABUT (605 FRWY) OVERPASS	Y 8919
ARTESIA (2005)	31.550 9.616	RDBM TAG IN E CB 300MM(1') N/O BCR @ NE COR CARSON ST & JUAN AVE	Y 8921
ARTESIA (2005)	29.673 9.044	RDBM TAG IN E CB 300MM(1') N/O BCR @ NE COR NORWALK BLVD & 221ST ST	Y 8924
ARTESIA (2005)	29.354 8.947	RDBM TAG IN W CB 600MM(2') N/O BCR @ NW COR NORWALK BLVD & RING ST	Y 8926
ARTESIA (2005)	29.151 8.885	CITY L B BR MON IN WELL 6IN DN @ C/L INT NORWALK BLVD & RING ST MKD (CLB 1966 RE 3111)	Y 8927
ARTESIA (2005)	28.430 8.665	RDBM TAG IN S CB 300MM(1') E/O ECR @ SW COR NORWALK BLVD & WARDLOW RD	Y 8929
ARTESIA (2005)	42.396 12.922	CS BM MON FL @ SE COR BRIDGE OVER LOS COYOTES CREEK 7.6M(25') E/O C/L NORWALK BLVD MKD (BM 8-24E 1970)	Y 8930

QUAD YEAR	ELEV FOOT/METER	DESCRIPTION	BM NUMBER
ARTESIA (2005)	40.643 12.388	RDBM TAG IN WING WALL SW COR BRIDGE OVER LOS COYOTES CRK S/O SLY ABUT & 9M(29.5') W/O C/L NORWALK BLVD	Y 8931
ARTESIA (2005)	36.581 11.150	CS MON IN WELL DN 200MM(0.7') IN CB RET 2.4M(8') N/O BCR @ SW COR PIONEER BL & CENTRALIA RD MKD (ARTESIA C-8 RM #3 RE 5869)	Y 8932
ARTESIA (2005)	40.193 12.251	RDBM TAG IN S CB 300MM(1') E/O BCR @ SE COR PIONEER BLVD & 207TH ST	Y 8934
ARTESIA (2005)	40.205 12.255	RDBM TAG IN W CB 600MM(2') N/O BCR @ NW COR PIONEER BLVD & 207TH ST	Y 8935
ARTESIA (2005)	56.092 17.097	L & BR IN E CB 2FT SO BCR @ SE COR PIONEER BL & 178TH ST 42FT E & 38FT SO C/L INT	Y 8941
ARTESIA (2005)	56.269 17.151	RDBM TAG IN E CB 4FT NO BCR @ NE COR PIONEER BL & 178TH ST 42FT E & 46FT NO C/L INT	Y 8942
ARTESIA (2005)	62.663 19.100	L&BR IN E CB 9.8M(32') N/O BCR @ NE COR PIONEER BL & FRAMPTON CT	Y 8943
ARTESIA (2005)	64.023 19.514	L & SM SPK IN NOSE FRWY ON RAMP (WESTBOUND) 43FT W & 130FT NO ARTESIA #91 FRWY	Y 8944
ARTESIA (2005)	70.067 21.356	RDBM TAG IN E CB 40FT E & 20FT NO C/L INT PIONEER BLVD & 162ND ST	Y 8945
ARTESIA (2005)	70.535 21.499	RDBM TAG IN W CB 40FT W & 20FT N C/L INT @ PIONEER BLVD & 162ND ST PROD	Y 8946
ARTESIA (2005)	65.783 20.051	RDBM TAG IN E CB 600MM(2FT) S BCR @ NE COR LUCAS ST BLOOMFIELD AVE	Y 8955
ARTESIA (2005)	65.282 19.898	RDBM TAG IN W CB 300MM(1FT) S/O BCR @ N END ISLE FOR (91) FRWY ON-RAMP W BND 13M(43FT) W & 47M(152FT) N/O C/L INT BLOOMFIELD AVE & LUCAS ST	Y 8956
ARTESIA (2005)	58.675 17.884	BN IN N CB @ NE COR BRIDGE OVER SAN GABRIEL RIV 40FT N & 180FT W C/L INT DEL AMO BLVD & STUDEBAKER RD	Y 8960
ARTESIA (2005)	55.686 16.973	RDBM TAG IN S CB 42FT S & 10FT W C/L INT DEL AMO BLVD & THE OFF RAMP OF THE SO BOUND 605 FRWY	Y 8962
ARTESIA (2005)	57.032 17.383	RDBM TAG IN N CB 4FT E BCR @ NE COR DEL AMO BLVD & THE OFF RAMP OF THE SO BOUND 605 FRWY 38FT N & 18FT E/O C/L INT	Y 8963
BASELINE (2005)	67.123 20.459	L&T IN S CB 5.2M(17') E/O BCR @ SE COR FIRESTONE BL & MARQUARDT AVE (S/O ALONDRA BL & FIRESTONE BL INT)	Y 9275
BASELINE (2005)	71.753 21.870	ST DIV OF HWYS TAG @ MCR @ NE COR ALONDRA BLVD & FIRESTONE BLVD	Y 9276
BASELINE (2005)	94.828 28.904	RDBM TAG IN S CB FIRESTONE BL & 402M(0.25MI) E/O NORWALK BL @ BLDG #12440 (W SIDE DRWY)	Y 9279
BASELINE (2005)	97.233 29.637	RAMSET & WASH IN N CB 1.2M(4') W/O BCR @ NW COR FIRESTONE BL & NORWALK BL MKD (STATE OF CALIF DIV HWYS)	Y 9280

QUAD YEAR	ELEV FOOT/METER	DESCRIPTION	BM NUMBER
BASELINE (2005)	89.401 27.250	L&N IN N CB 1.5M(5') W/O BCR @ NW COR ROSECRANS AVE & PIONEER BL (E END C. B.)	Y 9281
BASELINE (2005)	86.900 26.487	RAMSET IN CTR OF CB RET @ SW COR ROSECRANS AVE & WOODRUFF AVE	Y 9283
BASELINE (2005)	79.739 24.305	RDBM TAG IN W CB @ S END C. B. 6.4M(21') N/O BCR @ NW COR WOODRUFF AVE & WOODRUFF PL	Y 9284
BASELINE (2005)	93.997 28.650	FC MON IN WALK @ SW COR BRIDGE #B977 OVER SAN GABRIEL RIVER 12.5M(41') S/O C/L ALONDRA BLVD MKD (BM 075-00877 1974)	Y 9375
BASELINE (2005)	92.078 28.065	PK IN CB @ SE COR BRIDGE #B977 OVER SAN GABRIEL RIVER 11.7M(38') S/O C/L ALONDRA BLVD	Y 9376
BASELINE (2005)	75.259 22.939	CS MON IN S WALL C. B. @ NW COR STUDEBAKER RD & ALONDRA BLVD MKD (9-3C 1975 RE 7078)	Y 9377
BASELINE (2005)	74.228 22.625	L&BR IN CTR OF CB RET @ SE COR STUDEBAKER RD & ALONDRA BLVD	Y 9378
BASELINE (2005)	72.722 22.166	RDBM TAG IN E CB 900MM(3') S/O BCR @ SE COR FALCON WY EAST & STUDEBAKER RD (ENTRANCE RD TO CERRITOS COLLEGE)	Y 9379
BASELINE (2005)	65.989 20.114	RDBM TAG IN S WALL C. B. 7M(23') N/O BCR @ NE COR STUDEBAKER RD & ON-RAMP TO (91) FRWY E BOUND 13M(43') N/O & 13M(43') E/O C/L INT	Y 9381
BASELINE (2005)	63.279 19.287	CSBM MON IN E WALL C. B. 23M(75') W/O BCR @ NW COR STUDEBAKER RD & ARTESIA BLVD MKD (BM 9-6C 1965)	Y 9382
BASELINE (2005)	58.026 17.686	CSBM MON IN S WALL C. B. 1.5M(5') N/O BCR @ NW COR STUDEBAKER RD & 183RD ST MKD (BM 9-7B 1975)	Y 9383
BASELINE (2005)	71.954 21.932	FC MON IN WALK @ SW COR OF BRIDGE #B972 OVER SAN GABRIEL RIVER 12.8M(42') S/O C/L SOUTH ST MKD (BM 074-02797 1974)	Y 9385
BASELINE (2005)	42.036 12.813	RDBM TAG IN CB 900MM(3') S/O BCR @ SW COR ARBOR RD & PALO VERDE AVE	Y 9386
BASELINE (2005)	26.419 8.053	RAMSET IN E CB 300MM(1') S/O BCR @ SE COR METZ ST & PALO VERDE AVE	Y 9388
BASELINE (2005)	31.552 9.617	L&BN @ BCR @ SE COR PALO VERDE AVE & HARCO ST MKD (KN 233)	Y 9396
BASELINE (2005)	41.562 12.668	FC BR CAP MON 600MM(2') S/O CF SPRING ST @ SW COR OF BRIDGE OVER SAN GABRIEL RIVER 12M(39.5') S/O C/L MKD (BM 073-02202)	Y 9511
BASELINE (2005)	41.174 12.550	L&BR 600MM(2') S/O S CF SPRING ST 12M(39.5') S/O C/L @ SE COR BRIDGE OVER SAN GABRIEL RIVER	Y 9512
BASELINE (2005)	51.579 15.721	RDBM TAG IN S CB SPRING ST & 5.2M(17') W/O E END BRIDGE #53-1723 OVER (605) FRWY	Y 9513
BASELINE (2005)	23.857 7.272	RDBM TAG IN N CB 300MM(1') W/O BCR @ NW COR SPRING ST & PALO VERDE AVE	Y 9540

QUAD YEAR	ELEV FOOT/METER	DESCRIPTION	BM NUMBER
BASELINE (2005)	24.465 7.457	RDBM TAG IN N CB 300MM(1') E/O BCR @ NE COR SPRING ST & PALO VERDE AVE	Y 9541
ARTESIA (2005)	28.456 8.673	RDBM TAG IN S END C. B. 3M(10') N/O BCR @ NE COR NORWALK BLVD & WARDLOW RD	Y 9579
ARTESIA (2005)	29.710 9.056	CS BM MON IN WALK 430MM(1.4') E/O CF 3M(10') N/O BCR @ SE COR NORWALK BLVD & 223RD ST MKD (BM 8-22-A 1970 RE 5869)	Y 9580
ARTESIA (2005)	36.397 11.094	L&BR IN E CB 300MM(1') N/O BCR @ NE COR BLOOMFIELD AVE & GRADWELL ST	Y 9581
ARTESIA (2005)	37.316 11.374	CS BR MON 1M(3.3') E/O E CF 3.4M(11') S/O BCR @ SE COR BLOOMFIELD AVE & CENTRALIA RD MKD (BM 8-15A 1965) @ C. B.	Y 9582
ARTESIA (2005)	41.457 12.636	L&T IN CB RET 300MM(1') N/O BCR @ SE COR BLOOMFIELD AVE & DEL AMO BLVD	Y 9583
ARTESIA (2005)	47.236 14.398	CSBM MON IN S END C. B. 16M(52') N/O BCR @ NE COR SOUTH ST & BLOOMFIELD AVE MKD (BM 8-7A 1970)	Y 9585
ARTESIA (2005)	44.639 13.606	CSBM MON IN W END C. B. 54M(177') W/O BCR @ NW COR SOUTH ST & SHOEMAKER AVE 76M(250') W/O & 13M(43') N/O C/L INT MKD (BM 8-6A 1970)	Y 9586
ARTESIA (2005)	45.452 13.854	CSBM MON IN E END C. B. 13M(43') W/O BCR @ NW COR SOUTH ST & CARMENITA RD MKD (BM 8-5B 1970)	Y 9587
ARTESIA (2005)	52.595 16.031	L&T IN S CB 300MM(1') W/O BCR @ SW COR SOUTH ST & GRIDLEY RD	Y 9591
ARTESIA (2005)	71.905 21.917	L&BR IN N CB 300MM(1') W/O BCR @ NW COR ALONDRA BLVD & GRIDLEY RD	Y 9592
ARTESIA (2005)	71.865 21.905	L&BR IN N CB 300MM(1') E/O BCR @ NE COR ALONDRA BLVD & GRIDLEY RD	Y 9593
ARTESIA (2005)	72.829 22.198	RDBM TAG IN S CB 9M(29.5') W/O BCR @ SW COR ALONDRA BLVD & PIONEER BLVD	Y 9594
ARTESIA (2005)	71.992 21.943	L&BR IN E END C B 2M(2FT) W/O BCR @ NW COR ALONDRA BLVD & CARMENITA RD	Y 9596
ARTESIA (2005)	71.692 21.852	RAMSET IN E END C B 1.5M(5FT) W BCR @ SW COR ALONDRA BLVD & CARMENITA RD	Y 9597
ARTESIA (2005)	79.305 24.172	L&BR 1FT S/O BCR @ NW COR BLOOMFIELD AVE & EXCELSIOR DR 66FT N & 42FT W/O C/L INT	Y 9598
ARTESIA (2005)	76.816 23.414	L&BR 5FT N/O BCR @ NE COR BLOOMFIELD AVE & MOLETTE ST 58FT N & 42FT E/O C/L INT	Y 9599
ARTESIA (2005)	51.844 15.802	RAMSET & W IN CB RET 6M(20FT) N/O BCR @ SW COR BLOOMFIELD AVE & 183RD ST	Y 9600
ARTESIA (2005)	35.376 10.783	RDBM TAG IN E CB 600MM(2') N/O BCR @ NE COR PIONEER BLVD & 215TH ST	Y 9604

QUAD YEAR	ELEV FOOT/METER	DESCRIPTION	BM NUMBER
ARTESIA (2005)	53.901 16.429	L&T 5FT N/O BCR @ SW COR PIONEER BLVD & 183RD ST 46FT S & 43FT W/O C/L INT	Y 9606
ARTESIA (2005)	53.647 16.352	L&T CTR CB RET @ SE COR PIONEER BLVD & 183RD ST 44FT S & 49FT E/O C/L INT	Y 9607
ARTESIA (2005)	65.298 19.903	L&CAL-TRANS TAG 300MM(1FT) N/O BCR @ SW COR CARMENITA RD & 166TH ST	Y 9610
BASELINE (2005)	63.980 19.501	L&BR IN N CB 2.4M(8FT) E/O BCR @ NE COR VALLEY VIEW AVE & FIRESTONE BLVD (SOUTH SIDE OF 5 FRWY)	Y 10028
ARTESIA (2005)	66.183 20.173	L&BR IN N CB 300MM(2FT) E/O BCR @ NW COR 166TH ST & BLOOMFIELD AVE	Y 10073
ARTESIA (2005)	44.042 13.424	RAMSET IN W CB 300MM(1') N/O BCR @ NW COR 195TH ST & BLOOMFIELD AVE	Y 10075
ARTESIA (2005)	44.082 13.436	RAMSET IN S CB 300MM(1') E/O BCR @ SE COR 195TH ST & BLOOMFIELD AVE	Y 10076
BASELINE (2005)	87.165 26.568	DPW BM TAG N CB 300MM(1') W/O BCR @ NW COR FLATBUSH AVE & ROSECRANS AVE	Y 10225
BASELINE (2005)	86.887 26.483	DPW BM TAG N CB 300MM(1') E/O BCR @ NE COR FAIRFORD AVE & ROSECRANS AVE (SERV RD) 13M(43') E/O & 4.6M(15') N/O C/L INT	Y 10226
BASELINE (2005)	66.318 20.214	DPW BM TAG IN CONC BASE TRAFFIC SIGNAL 8M(26.2FT) N/O C/L PROD FIRESTONE BLVD & 13M(43FT) W/O C/L VALLEY VIEW AVE (S SIDE 5 FRWY)	Y 10227
BASELINE (2005)	22.298 6.796	CLB BR DISC IN CONC PAD 300MM(1') S/O CF 6.4M(21') W/O BCR @ SW COR SPRING ST & LADOGA AVE MKD (BM 871 RCE 9675 RESET 1976)	Y 10235
BASELINE (2005)	29.013 8.843	DPW BM TAG IN W CB 300MM(1') N/O BCR @ NW COR PALO VERDE AVE & WARDLOW RD	Y 10236
BASELINE (2005)	39.575 12.062	L&BN IN E CB 300MM(1') S/O BCR @ SE COR PALO VERDE AVE & CENTRALIA ST	Y 10237
BASELINE (2005)	57.888 17.644	L&BR IN CB RET 5.5M(18') N/O BCR @ SW COR STUDEBAKER RD & 183RD ST	Y 10238
ARTESIA (2005)	33.041 10.071	DPW BM TAG IN N CB 300MM(1') W/O BCR @ NW COR CARSON ST & NORWALK BLVD	Y 10312
ARTESIA (2005)	51.964 15.839	DPW BM TAG IN N CB 6M(20') W/O BCR @ NW COR 183RD ST & CARMENITA RD @ C. B.	Y 10314
ARTESIA (2005)	55.603 16.948	DPW BM TAG IN W CB 4M(13') N/O BCR @ NW COR ROSE ST & CARMENITA RD @ C. B.	Y 10315
ARTESIA (2005)	59.625 18.174	DPW BM TAG IN W CB 300MM(1') S/O BCR @ SW COR ARTESIA BLVD & CARMENITA RD	Y 10316
ARTESIA (2005)	57.121 17.411	DPW BM TAG IN N CB 300MM(1') W/O BCR @ NE COR ARTESIA BLVD & MARQUARDT AVE	Y 10317

QUAD YEAR	ELEV FOOT/METER	DESCRIPTION	BM NUMBER
ARTESIA (2005)	36.571 11.147	CLB MON IN CONC WALK 5M(16.4') S/O BCR @ SW COR CARSON ST & LOS COYOTES DIAGONAL MKD (CLB BM 1981)	Y 10318
ARTESIA (2005)	46.123 14.058	DPW BM TAG W CB 1.5M(5FT) N/O BCR @ NW COR PIONEER BLVD & 195TH ST	Y 10323
ARTESIA (2005)	46.091 14.049	DPW BM TAG IN E CB 13M(43FT) N/O BCR @ NE COR 195TH ST & PIONEER BLVD	Y 10324
BASELINE (2005)	30.020 9.150	L&BN IN E CB 1M(3.3') S/O BCR @ SE COR PALO VERDE AVE & KEYNOTE ST (NR C. B.)	Y 11071
BASELINE (2005)	32.873 10.020	CLB BR DISC IN CONC PAD 300MM(1') E/O BCR @ NE COR PALO VERDE AVE & CONANT ST 21M(69') E/O & 6M(20') N/O C/L INT MKD (BM 1981)	Y 11072
BASELINE (2005)	31.987 9.750	CLB BR DISC IN CONC PAD 6M(19.7') W/O BCR @ NE COR PALO VERDE AVE & HARCO ST 15.5M(51') E/O & 7.3M(24') N/O C/L INT MKD (BM 1981)	Y 11073
BASELINE (2005)	53.013 16.158	L&T IN W CB @ C. B. 1M(3.3') N/O BCR NW COR PALO VERDE AVE & SOUTH ST	Y 11074
BASELINE (2005)	55.475 16.909	L&T IN E CB 5.5M(18') S/O BCR @ SE COR STUDEBAKER RD & AUTO SQUARE DR	Y 11075
BASELINE (2005)	60.982 18.587	DPW BM TAG IN E CB STUDEBAKER RD & 10.4M(34') S/O C/L DRWY TO BLDG #17720 (@ PP)	Y 11076
BASELINE (2005)	21.776 6.637	DPW BM TAG IN S CB 1M(3.3') E/O BCR @ SE COR SPRING ST & LADOGA AVE NR C. B.	Y 11081
BASELINE (2005)	23.222 7.078	CLB BR DISC IN CONC PAD @ E END C. B. 8M(26') W/O BCR SW COR SPRING ST & STUDEBAKER RD MKD (CLB BM 1981)	Y 11082
ARTESIA (2005)	43.324 13.205	L&PK IN E CB 300MM(1') N/O BCR @ NE COR BLOOMFIELD AVE & ENT TO CERRITOS SPORTS COMPLEX	Y 11130
BASELINE (2005)	60.882 18.557	DPW BM TAG IN W CB 1M(3.3FT) S/O BCR @ SW COR VALLEY VIEW AVE & ARBOR PL	Y 11132
BASELINE (2005)	86.048 26.228	DPW BM TAG IN N CB 18M(59') E/O BCR @ NE COR ROSECRANS AVE & STUDEBAKER RD	Y 11133
BASELINE (2005)	103.354 31.502	COE MON IN W ABUT SW COR BRIDGE OVER SAN GABRIEL RIVER 9M S/O C/L ROSECRANS AVE MKD (SG 21 1959)	Y 11134
ARTESIA (2005)	74.925 22.837	DPW BM TAG IN N CB (SERV RD) 4M(13') W/O BCR @ NW COR ALONDRA BL & ELMCROFT AVE	Y 11135
ARTESIA (2005)	72.428 22.076	L&T IN N CB 7.5M(25FT) E/O BCR @ NE COR ALONDRA BLVD & BLACKBURN AVE	Y 11137
ARTESIA (2005)	50.007 15.242	DPW BM TAG IN E CB 8M(29FT) S/O BCR @ SE COR BLOOMFIELD AVE & ENTRANCE TO HERITAGE PARK	Y 11138
ARTESIA (2005)	51.953 15.835	DPW BM TAG IN W CB 2M(7FT) N/O BCR @ NW COR BLOOMFIELD AVE & 183RD ST (NR C B)	Y 11139

QUAD YEAR	ELEV FOOT/METER	DESCRIPTION	BM NUMBER
ARTESIA (2005)	54.138 16.501	DPW BM TAG IN W CB 5M(16FT) N/O BCR @ NW COR BLOOMFIELD AVE & FELSON ST @ C B	Y 11140
ARTESIA (2005)	59.553 18.152	DPW BM TAG IN W CB 14M(46FT) N/O BCR @ NW COR ARTESIA BLVD & BLOOMFIELD AVE	Y 11141
ARTESIA (2005)	68.657 20.927	L&T IN W CB 600MM(2FT) S/O BCR @ SW COR BLOOMFIELD AVE & HIDDEN CREEK WAY	Y 11142
ARTESIA (2005)	46.529 14.182	DPW BM TAG IN S CB 10.4M(34') W/O BCR @ SW COR SOUTH ST & NORWALK BLVD @ C. B.	Y 11143
ARTESIA (2005)	34.278 10.448	L&BR IN N CB 4M(13') E/O BCR @ NE COR CARSON ST & NECTAR AVE (W END C. B.)	Y 11144
ARTESIA (2005)	46.498 14.173	LACO BM TAG IN S CB 22M(75') E/O BCR @ SE COR SOUTH ST & NORWALK BLVD	Y 11432
ARTESIA (2005)	36.709 11.189	LACO BM TAG IN N CB 4M(13') W/O BCR @ NW COR CARSON ST (SERV RD) & KNOXVILLE AVE	Y 11433
ARTESIA (2005)	37.364 11.389	L&LS5411TAG IN S CB CARSON ST (SERV RD) ON C/L PROD KNOXVILLE AVE	Y 11434
ARTESIA (2005)	34.160 10.412	L&T IN N CB 3M(10') W/O BCR @ NW COR CARSON ST & NECTAR AVE	Y 11435
ARTESIA (2005)	35.164 10.718	LACO BM TAG IN S CB CARSON ST @ ON-RAMP 605 FRWY S BND 21M(69') S/O C/L & 4M(13') W/O LT STD #B1751 (E END C.B.)	Y 11436
ARTESIA (2005)	34.362 10.474	LACO BM TAG IN S CB 1M(3.3') E/O BCR @ SE COR CARSON ST & PIONEER BLVD	Y 11437
ARTESIA (2005)	34.214 10.428	LACO BM TAG IN N CB @ BCR @ NE COR CARSON ST & PIONEER BLVD	Y 11438
ARTESIA (2005)	32.313 9.849	L&DPW TAG IN S CB CARSON ST & 42M(138') W/O C/L PROD CLARETTA AVE @ BLDG #12354	Y 11440
ARTESIA (2005)	31.985 9.749	L&DPW TAG IN S CB CARSON ST & 15.6M(51') E/O C/L PROD CLARETTA AVE @ BLDG 12404	Y 11441
ARTESIA (2005)	40.854 12.452	CS DISK IN N CB 3M(10') W/O BCR @ NW COR PIONEER BL & DEL AMO BL MKD (ARTESIA RM NO 6 1962 RE 5869)	Y 11442
ARTESIA (2005)	42.844 13.059	L&N IN E CB @ BCR NE COR PIONEER BLVD & EBERLE ST	Y 11443
ARTESIA (2005)	29.621 9.029	L&BN IN W CB 1M(3.3') S/O BCR @ SW COR NORWALK BLVD & 221ST ST	Y 11444
ARTESIA (2005)	35.286 10.755	LACO BM TAG IN E CB 1.4M(4.7') N/O BCR @ NE COR BLOOMFIELD AVE & 215TH ST	Y 11445
ARTESIA (2005)	47.242 14.399	LACO BM TAG IN E CB @ BCR @ SE COR CARMENITA AVE & DROXFORD ST	Y 11446
BASELINE (2005)	59.811 18.230	L&DPW TAG IN W CB 300MM(1FT) S/O ECR @ SW COR VALLEY VIEW AV & PARK PL	Y 11901

QUAD YEAR	ELEV FOOT/METER	DESCRIPTION	BM NUMBER
BASELINE (2005)	88.469 26.965	L&DPW TAG @ MCR @ SE COR ROSECRANS AV & JERSEY AV	Y 12001
BASELINE (2005)	85.636 26.102	L&LS TAG#5411 IN W CB 7.6M(25FT) N/O BCR @ NW COR FIRESTONE BL & ROSECRANS AV	Y 12002
ARTESIA (2005)	80.987 24.685	L&LACO DPW TAG IN S CB 300MM(1FT) W/O BCR @ SW COR FIRESTONE BL & SHOEMAKER AV	Y 12003
BASELINE (2005)	83.148 25.344	L&DPW TAG IN S CB FIRESTONE BL 300MM(1FT) W/O EL MONTE RV ENT TO BLDG #12818	Y 12004
BASELINE (2005)	68.704 20.941	L&LAFCC TAG IN CONC WALK OF COYOTE CREEK BRIDGE 19.8M(65FT) E/O C/L BRIDGE ON FIRESTONE BL	Y 12005
BASELINE (2005)	71.028 21.649	L&DPW TAG IN E CB 3.7M(12') S/O BCR @ SE COR STUDEBAKER RD & 166TH ST @ F.H.	Y 12263
BASELINE (2005)	52.849 16.108	L&DPW TAG IN E CB 15.2M(50') N/O ECR @ NE COR SOUTH ST & STUDEBAKER RD 300MM(1') N/O C.B.	Y 12264
BASELINE (2005)	46.864 14.284	L&DPW TAG IN E CB 900MM(3') N/O BCR @ SE COR PALO VERDE AV & DEL AMO BL @ PP	Y 12265
BASELINE (2005)	38.442 11.717	L&DPW TAG IN W CB 900MM(3') N/O BCR @ NW COR PALO VERDE AV & HARVEY WY	Y 12266
ARTESIA (2005)	24.405 7.439	L&RD TAG IN S CB SPRING ST @ C/L PROD VOLK AV	Y 12301
ARTESIA (2005)	26.684 8.133	CLB BRASS DISK IN CONC PAD 300MM(1') S/O S CF 3.7M(12') W/O BCR @ SW COR SPRING ST AND EL DORADO PARK	Y 12302
ARTESIA (2005)	26.465 8.067	L&DPW TAG IN E CB 300MM(1') S/O BCR @ NE COR LOS ALAMITOS BL & CERRITOS AV	Y 12303
ARTESIA (2005)	32.471 9.897	L&DPW TAG IN E CB 1.8M(6') S/O BCR @ SE COR NORWALK BL & CARSON ST	Y 12304
ARTESIA (2005)	58.988 17.980	L&DPW TAG IN S CB ARTESIA BL 12.2M(40') W/O C/L PROD STOWERS AV	Y 12305
ARTESIA (2005)	50.473 15.384	L&DPW TAG IN N CB 1.5M(5') W/O BCR @ NW COR SOUTH ST & CLARKDALE AV	Y 12306
ARTESIA (2005)	49.286 15.022	L&DPW TAG IN N CB 1.5M(5') E/O BCR @ NE COR SOUTH ST & CLARKDALE AV	Y 12307
ARTESIA (2005)	31.328 9.549	L&DPW TAG IN N CB 300MM(1') W/O BCR @ NW COR CARSON ST & JUAN AV	Y 12308
ARTESIA (2005)	40.690 12.402	L&DPW TAG IN S CB 1.5M(5') E/O BCR @ SW COR DEL AMO BL & PIONEER BL	Y 12309
ARTESIA (2005)	65.759 20.043	L&DPW TAG IN W CB 300MM(1') S/O BCR @ SW COR BLOOMFIELD AV & 166TH ST	Y 12310

QUAD YEAR	ELEV FOOT/METER	DESCRIPTION	BM NUMBER
ARTESIA (2005)	37.632 11.470	L&BR IN CB RET 7.9M(26') S/O BCR @ NW COR PIONEER BL & CENTRALIA RD	Y 12311
ARTESIA (2005)	72.787 22.186	L&DPW TAG IN N CB 5.2M(17') W/O BCR @ NW COR ALONDRA BL & PIONEER BL	Y 12312
ARTESIA (2005)	59.333 18.085	L&DPW IN E CB 300MM(1') N/O BCR @ SE COR PIONEER BL & ARTESIA BL	Y 12313
ARTESIA (2005)	56.994 17.372	L&DPW IN S CB 600MM(2') E/O BCR @ SE COR ARTESIA BL & ELAINE AV	Y 12314
ARTESIA (2005)	66.228 20.186	L&DPW IN E CB 3M(10') N/O BCR @ SE COR PIONEER BL & 166TH ST	Y 12315
ARTESIA (2005)	67.863 20.685	L&DPW TAG W.CURB CARENITA RD @ CL PROD VILLAGE DR	Y 12316
ARTESIA (2005)	45.746 13.943	L&DPW TAG S. CURB DEL AMO BLVD 5.5M(18FT) W/O CL E'LY DRWY TO BLDG 6540 (FIRST SOUTHERN BAPTIST CHURCH)	Y 12317
ARTESIA (2005)	57.284 17.460	L&DPW TAG IN S. CURB 3M(10FT) W/O BCR @ SW COR DEL AMO BLVD & STUDEBAKER RD	Y 12318
ARTESIA (2005)	40.310 12.287	L&DPW TAG IN N. CURB 1M(3FT) E/O BCR @ NE COR DEL AMO BLVD & STUDEBAKER RD	Y 12319
ARTESIA (2005)	85.778 26.145	L&LS5411 TAG IN E CB 10.7M(35') S/O BCR @ SE COR BLOOMFIELD AV & ROSECRANS AV	Y 12320
ARTESIA (2005)	81.065 24.709	L&LACO DPW TAG IN W CB 900MM(3') N/O BCR @ NW COR BLOOMFIELD AV & MAPLEDALE ST	Y 12321
ARTESIA (2005)	73.768 22.485	L&LACO DPW TAG IN E CB 900MM(3') N/O BCR @ SE COR SHOEMAKER AV & MOLETTE ST	Y 12322
ARTESIA (2005)	76.385 23.282	L&CALTRANS TAG IN W CB 900MM(3') N/O BCR @ NW COR SHOEMAKER AV & EXCELSIOR DR	Y 12323